

AC-Electroic Current Transducer STWA2AH

with analog output

STWA2AH
Electronic current trans-
former
AC 0...20 A / 0...100 A -
DC 4...20 mA

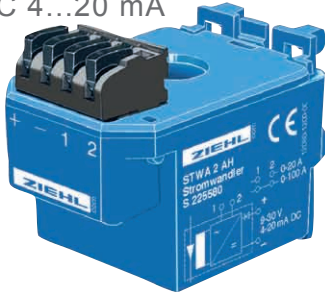

The STWA2AH is a measuring transducer for AC currents 0...100 A, divided in 2 ranges 0...20 A and 0...100 A. Multiple loops of the conductor through the transformer reduces the measuring range correspondingly (for instance to 0...5 A with four loops).

For the monitoring of currents of any level, the STWA2AH is simply looped into the secondary circuit of a large transformer with secondary 5 A (cable four times through the STWA2AH). Consequently, the output is proportional to the primary current of the transformer, e.g. 0...100 A for a transformer with 100/5 A.

The analog output is isolated. The STWA2AH is in 2-wire execution

and needs a supply-voltage DC 9...30 V.

Application: The STWA " AH makes it possible to monitor the value of an AC current. The output signal can be evaluated or displayed with components with analog inputs, e.g. ZIEHL TR210, STW1000V2 or MINIPAN®.

- current-proportional analog output DC 4...20 mA = AC 0...20 / 0...100 A (isolated)
- electrical connection via screwless pluggable terminals
- supply voltage DC 9...30 V (2-wire)
- DIN-rail-mount or with screws
- plug-in current transformer (Ø 11 mm)
- max. overload 100 A continuously, 300 A / 10 s

Order-number **S225580**

Supply voltage	DC 9...30 V (2-wire), depending on load
Monitoring ranges	AC 0 - 20 / 0...100 A
Analog output	DC 4 - 20 mA (max. 32 mA)
Adjustment time	< 0,5 s.
Error (of scale, above 10% / I rated)	<5% (50 - 300 Ω)
Error with other load	+5%/100 Ω, max. 500 Ω
Temperature coefficient	< 0,06%/K
Nominal frequency	50 Hz
Operating range	30...400 Hz
Error	≤ 0,2%/Hz
Overload cap. continous / 10s	100 A / 300 A
Rated ambient temperature range	0...55°C
Housing	Design H
Dimensions (h x w x d)	42 x 36 x 56 mm
Diameter for conductor	11 mm
Weight	app. 90 g

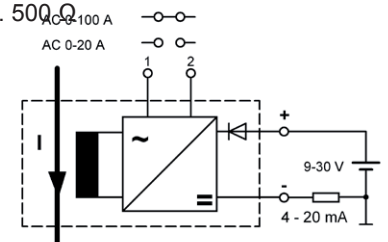

Dimension illustrations

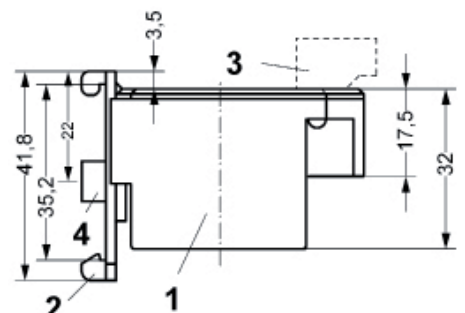
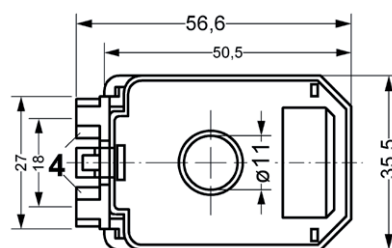

- 1 Housing
- 2 Clip for DIN-rail (removeable)
- 3 Terminal (pluggable)
- 4 Wall-mounting (M4)